

SPINNING REEL — ST1305

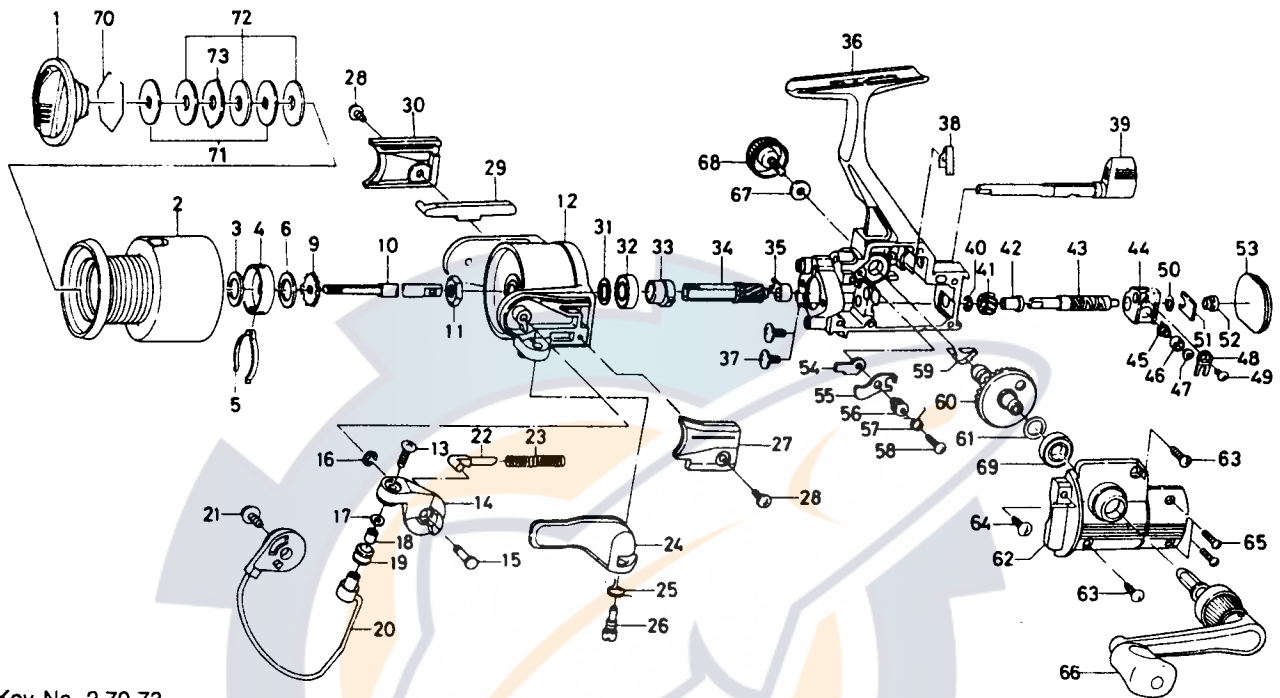

Key No. 2.70-73
 E27-2204 Spool assembly

Key				Key			
No.	Part No.	Part Name	Price	No.	Part No.	Part Name	Price
1	E27-2802	Drag knob	6.50	39	E36-3211	Anti-reverse lever	1.70
2	E27-2304	Spool assembly	N/A*	40	B33-9801	Worm shaft gear retainer	.35
3	375-4200	Spool washer	.35	41	E41-7101	Worm shaft gear	1.60
4	E12-2303	Click leaf spring holder	1.80	42	E39-3501	Worm shaft bush	.90
5	B74-7702	Spool click leaf spring	.45	43	E27-1601	Worm shaft	7.00
6	E39-4001	Main shaft washer	.70	44	F02-4301	Oscillating slider	3.70
9	E36-5301	Click gear	.70	45	E19-1202	Oscillating pawl	5.90
10	E48-0201	Main shaft	2.40	46	E19-1301	Oscillating pawl bush	2.80
11	341-9201	Rotor nut	.55	47	375-0800	Oscillating pawl washer	.50
12	E36-8001	Rotor	5.90	48	E24-4901	Oscillating slider cover	.90
13	B67-9304	Line roller screw	.40	49	E15-0203	Oscillating slider cover screw	.70
14	E36-9501	Bail arm	1.65	50	375-4100	Worm shaft washer	.30
15	E36-9601	Bail arm screw	1.40	51	E36-3801	Worm shaft retainer	.70
16	320-5901	Bail arm screw retainer	.50	52	E39-3601	Worm shaft collar	1.10
17	B55-4301	Line roller washer	.40	53	E36-7508	Rear cover	2.60
18	B45-1501	Line roller collar	.60	54	B95-9301	Anti-reverse pawl plate	.70
19	250-3921	Line roller	.90	55	E27-1301	Anti-reverse pawl	1.15
20	E37-1401	Bail assembly	4.75	56	B95-9501	Anti-reverse pawl collar	.60
21	E00-7101	Bail trip cam screw	.75	57	B95-9602	Anti-reverse pawl spring A	.60
22	E36-4401	Bail spring shaft	.70	58	B00-8601	Anti-reverse pawl screw	.35
23	E39-0601	Ball spring	.60	59	E24-5301	Anti-reverse pawl spring B	1.60
24	E36-9801	Trigger lever	2.70	60	F00-7101	Drive gear	3.70
25	E36-9901	Trigger spring	.70	61	375-8501	Drive gear washer	.45
26	E41-7801	Trigger screw	1.15	62	E36-7404	Side cover	3.90
27	E36-9703	Bail spring cover	1.15	63	E15-8601	Side cover screw A	.60
28	E36-4201	Bail spring cover screw	.60	64	E15-8602	Side cover screw B	.60
29	E36-5002	Bail trip lever	1.40	65	E11-9601	Side cover screw C	.70
30	E36-5103	Bail trip cover	1.20	66	E41-7901	Handle assembly	6.50
31	375-8503	Bearing washer	.70	67	F02-0201	Handle lock washer	.35
32	L03-6601	Ball bearing A	7.10	68	F03-5601	Handle lock screw	2.10
33	F03-7501	Anti-reverse ratchet	1.10	69	634-1301	Ball bearing B	7.65
34	E41-7001	Pinion gear	6.50	70	171-7701	Drag washer retainer	.35
35	E24-3301	Pinion collar	.70	71	E13-6101	Key washer	.80
36	E48-0301	Body assembly	9.50	72	E13-6001	Drag washer	.70
37	E03-7801	Bearing retainer screw	.60	73	E13-6201	Eared washer	.70
38	E26-8701	Anti-reverse cam spring	.60				